

48" SPAN 2

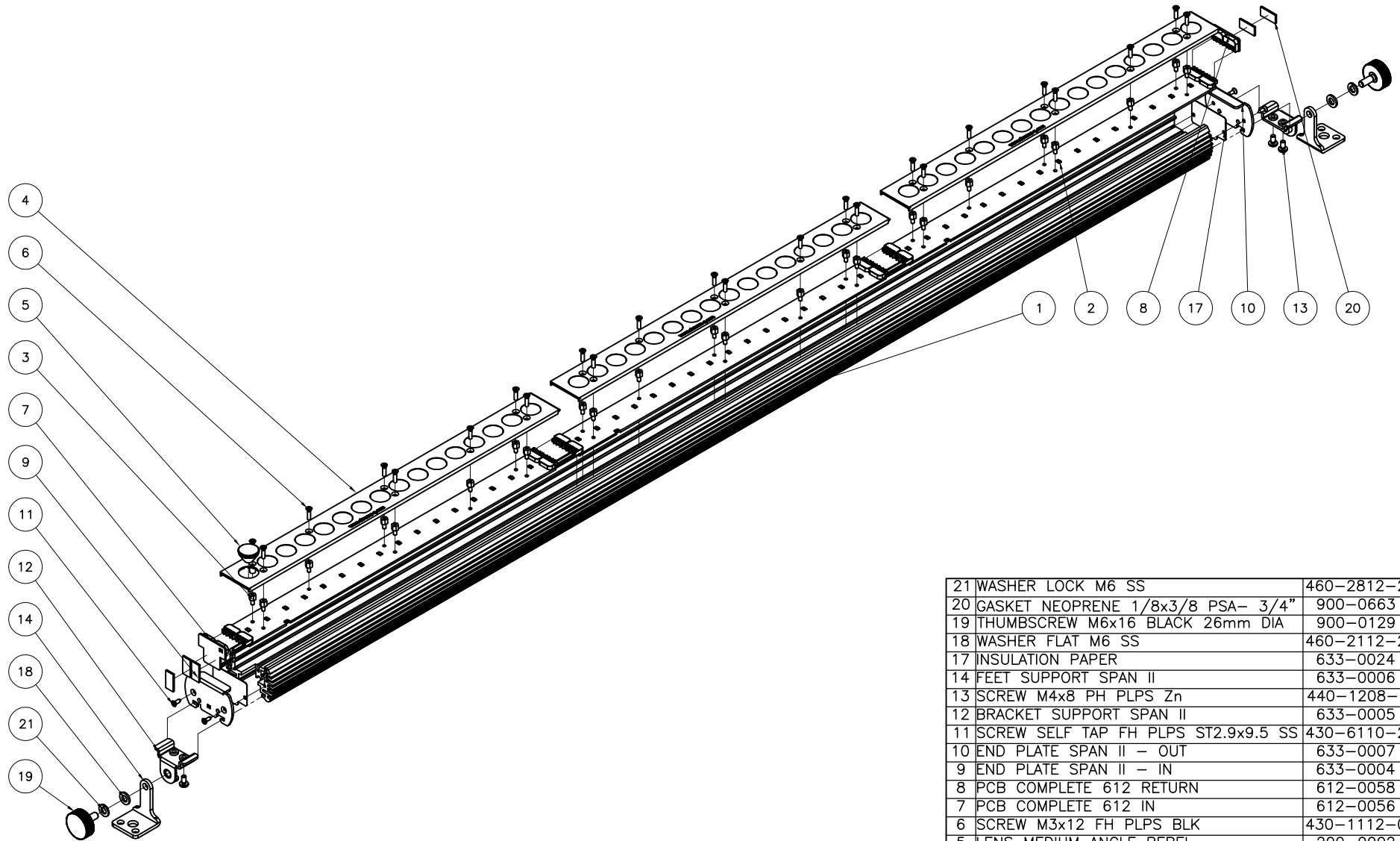

21	WASHER LOCK M6 SS	460-2812-2	2
20	GASKET NEOPRENE 1/8x3/8 PSA- 3/4"	900-0663	5
19	THUMBSCREW M6x16 BLACK 26mm DIA	900-0129	2
18	WASHER FLAT M6 SS	460-2112-2	2
17	INSULATION PAPER	633-0024	2
14	FEET SUPPORT SPAN II	633-0006	2
13	SCREW M4x8 PH PLPS Zn	440-1208-1	4
12	BRACKET SUPPORT SPAN II	633-0005	2
11	SCREW SELF TAP FH PLPS ST2.9x9.5 SS	430-6110-2	4
10	END PLATE SPAN II - OUT	633-0007	1
9	END PLATE SPAN II - IN	633-0004	1
8	PCB COMPLETE 612 RETURN	612-0058	1
7	PCB COMPLETE 612 IN	612-0056	1
6	SCREW M3x12 FH PLPS BLK	430-1112-0	24
5	LENS MEDIUM ANGLE REBEL	200-0002	48
4	HOLDER LENS COLOR SPAN MK2	612-0050	3
3	STD OFF M3 NUTx5, SCREW M3x6	430-4105-1	24
2	PCB COMPLETE LEDS SPAN II	633-0200	3
1	EXTRUSION SPAN II 48" SILVER	633-0014	1
ITEM	DESCRIPTION	PART#	QTY
Parts List			

DISCLAIMER: Dimensions and illustrative drawings contained herein are accurate to the company's knowledge at the time of printing, however specifications are subject to change without notice