

8 7 6 5 4 3 2 1

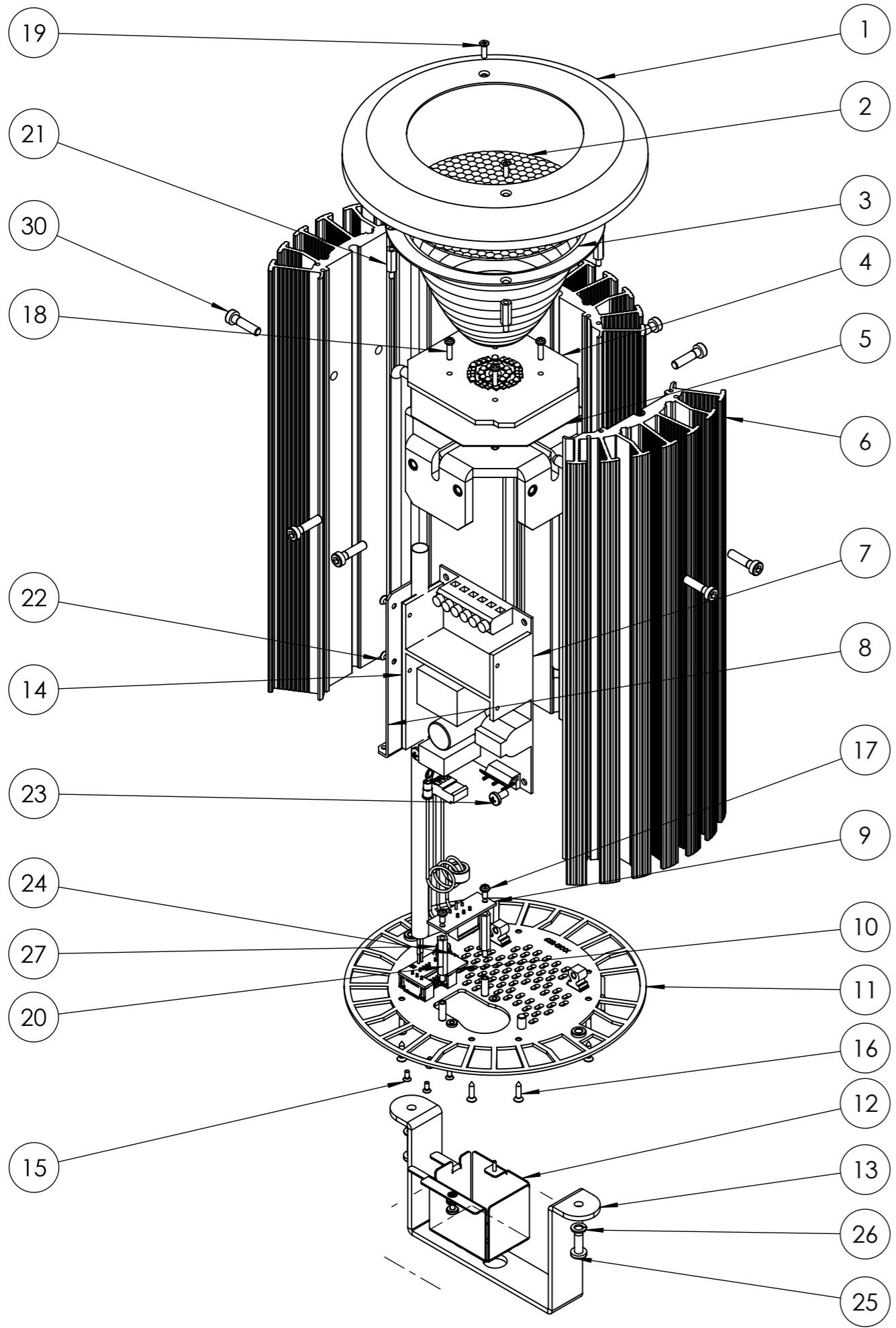

NO.	PART NUMBER	DESCRIPTION	QTY.
1	632-0506 / 632-0508	CAP CLOSING INSPIRE BLK / WHT	1
2	631-0021/ 632-0022	LENS NARROW/MEDIUM FOR OP-5LN2-0445	1
3	632-0505	REFLECTOR PARABOLIC SPUN INSPIRE COATED PCB	1
4	632-01004	COM ENGN REG TS	1
5	900-1180	THERMAL PAD ENGN	1
6	632-0502/ 632-0521	EXTRUSION INSPIRE REG BLK/WHT	1
7	632-0406	S/A PSU WITH HARN CAP, PAD AND SILICONE RUBBER 22V 6.0A	1
8	632-0006	PSU SUPPORT BRKT	1
9	632-0106	PCB COMPLETE HOUSE LIGHT MAINS	1
10	632-0107	PCB COM DMX IN/OUT	1
11	632-0005 / 632-0626	BACK PLATE INSPIRE XT TERMINAL STRIP	1
12	632-0086 / 632-0087	CONNECTOR BOX BLK / WHT	1
13	631-0005/ 632-0519	BRACKET HANDLE HOUSE LIGHT	1
14	900-1170	THERMAL PAD PSU INSPIRE XT	1
15	425-1106-0	M2.5X6 FH PLPS	4
16	429-6113-9 / 429-6113-2	SCREW SELF TAP FH PZDV BLK ST2.9x13 RoHS SCREW,	8
17	430-1206-0	M3x6 PH PLPS BLK	2
18	430-1212-0	SCREW M3x12 PH BLK	1
19	430-1110-0	SCREW M3x10 FH PLPS BLK	4
20	430-4125-1	STDOFF M-F M3x25x7, 6mm STUD	2
21	430-4115-1	STDOFF M-F M3x15x7, 6mm STUD	4
22	430-1106-0 / 430-1106-2	SCREW M3x6 FH PLPS BLK/ WHT	2
23	440-1208-1	SCREW M4x8 PH PLPS BLK	2
24	450-2609-1	WASHER LOCK M5 EXT TOOTH Zn	1
25	450-1212-0 / 450-1212-1	SCREW M5x12 PH BLK/ZN	2
26	450-2809-4	WASHER LOCK M5 (+)	2
27	450-3205-0	NUT HEX M5 COMBI BLK	1
28	450-1420-4	SCREW M5X20 SHCS ST	8
29	632-0302	HARNES CAPACITOR NOISE	1



ALL INFORMATION CONTAINED IN THIS DOCUMENT IS PROPERTY OF CHROMA-Q AND MAY NOT BE REPRODUCED IN WHOLE OR PART WIHOUT PERMISSION OF CHROMA-Q

UNLESS OTHERWISE SPECIFIED ALL DIMENSIONS ARE IN MM [INCHES]

TITLE:  
**INSPIRE REG TS BLK/WHT  
NARROW/MED/WIDE**

THIRD ANGLE PROJECTION

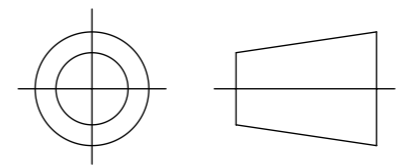

SIZE <b>A3</b>	PART NO. <b>632-15XX, 632-16XX, 632-17XX</b>	REV <b>C</b>
-------------------	---	-----------------

SCALE: 1:10 WEIGHT: SHEET 1 OF 1

8 7 6 5 4 3 2 1